

DRAFT

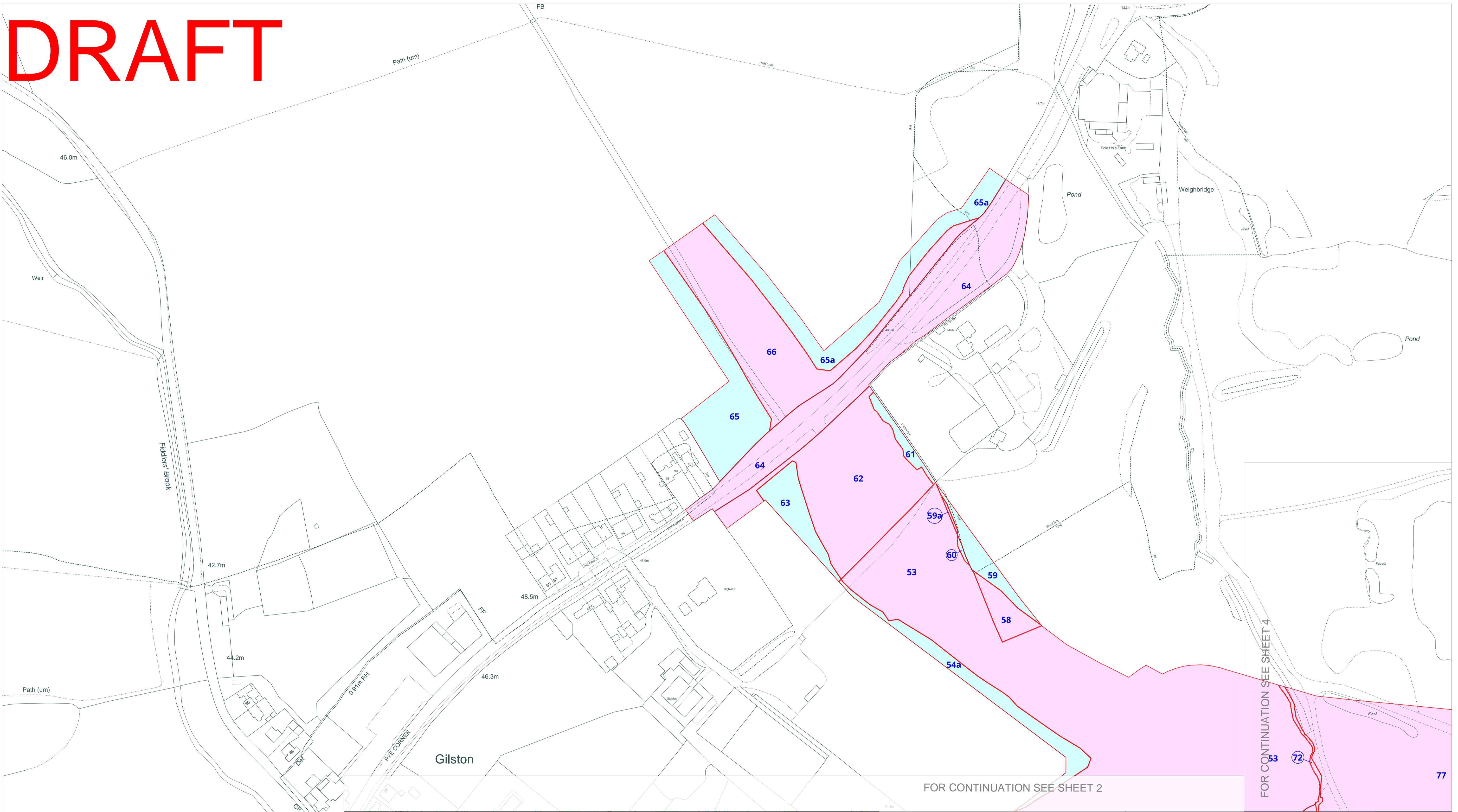

FOR CONTINUATION SEE SHEET 2

FOR CONTINUATION SEE SHEET 4

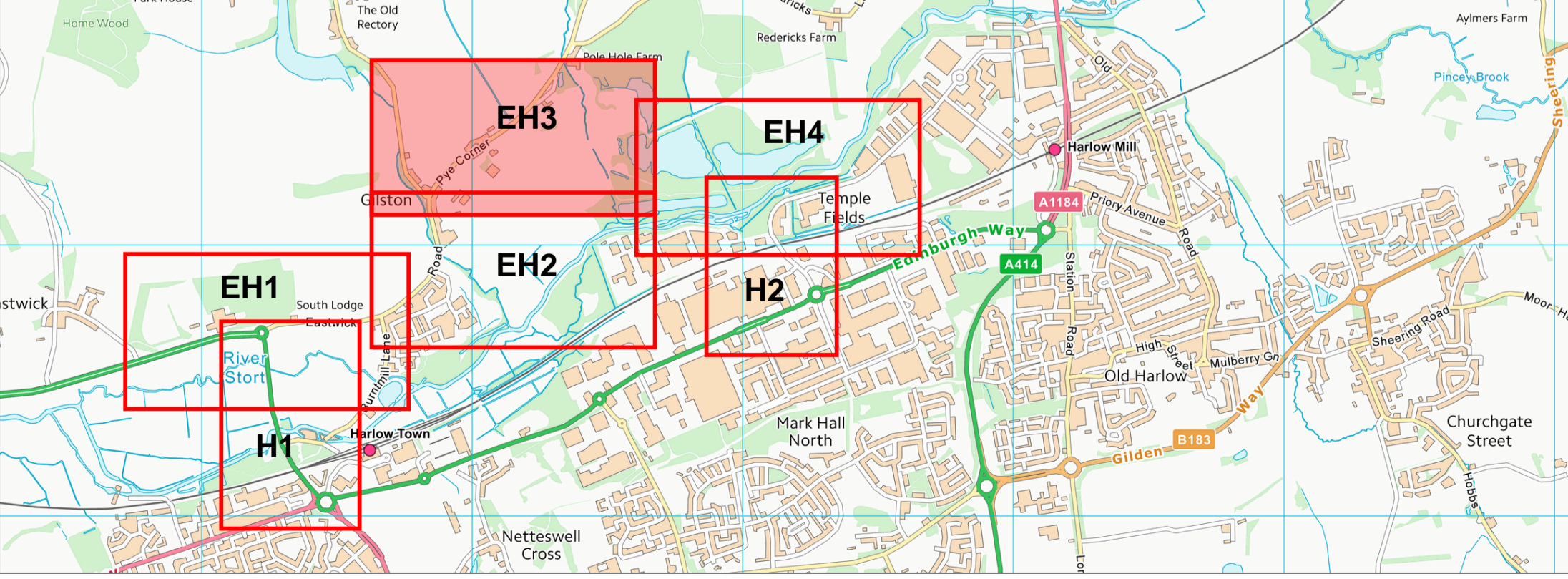

- Key:**
- Land to be acquired
 - New rights to be acquired
 - Bridges or airspace for bridges to be acquired with rights to be created above and below

The Common Seal of EAST HERTFORDSHIRE DISTRICT COUNCIL was hereunto affixed and this order(s) thereby executed in the presence of:-

Head of Legal and Democratic Services
East Hertfordshire District Council
Date 2022

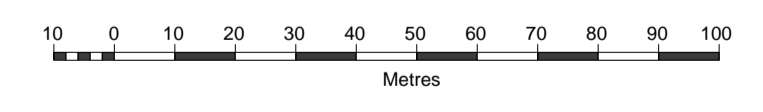

Date: 02/03/2022
Version Number: v5.3
Sheet Number: Sheet 3 of 4
Plan EH3
Scale: 1:1250 @ A1

Numbers not used
14, 52, 56, 57, 67, 68, 69,
70, 79, 79a

Where applicable the plot boundaries show the general boundary of the registered land, it does not show the exact line of the boundaries. Measurements scaled from this plan may not match measurements between the same points on the ground.

This map is based upon Ordnance Survey material with the permission of Ordnance Survey on behalf of the Controller of Her Majesty's Stationery Office © Unauthorised reproduction infringes crown copyright and may lead to prosecution or civil proceedings. Crown copyright and database rights 2022 Ordnance Survey Licence number: 0100031673

